



Plantation Wharf Battersea SW11

A wonderful opportunity to rent a spacious two bedroom barge at Plantation Wharf. With generous proportions throughout, the split level living space benefits from wood burner and a retractable roof making the space particularly special in the summer months. On the upper level is a sun room with stairs leading down to the lower level. The accommodation comprises large separate kitchen, two good size bedrooms, and a well finished bathroom.

Plantation Wharf is a desirable development which benefits from 24 hour concierge and is located on

the south banks of the Thames, close to the shops, eateries and bars of Battersea Square and Wandsworth Town. The development is located close to Wandsworth Town and Clapham Junction National Rail Station (overground) and just a short walk from the amenities of Battersea. The Thames Clipper riverboat service on site provide regular and fast connections to key commuter hubs including Canary Wharf, Tower Hill, London Bridge, Greenwich, Embankment and Waterloo.

KEY FEATURES

Local Authority: London Borough of Wandsworth

Spacious two bedroom barge

Split level living space

Wood burning stove

Large separate kitchen

24 hour concierge service

Internal area: 1,263 sq. ft. / 117 sq. m.





KEY INFORMATION

Local authority:	London Borough of Wandsworth
Internal area:	1,263 sq. ft. / 117 sq. m.
Garden area:	Deck
No. of bedrooms:	2
Council tax:	Band A

PLANTATION WHARF PIER, SW11

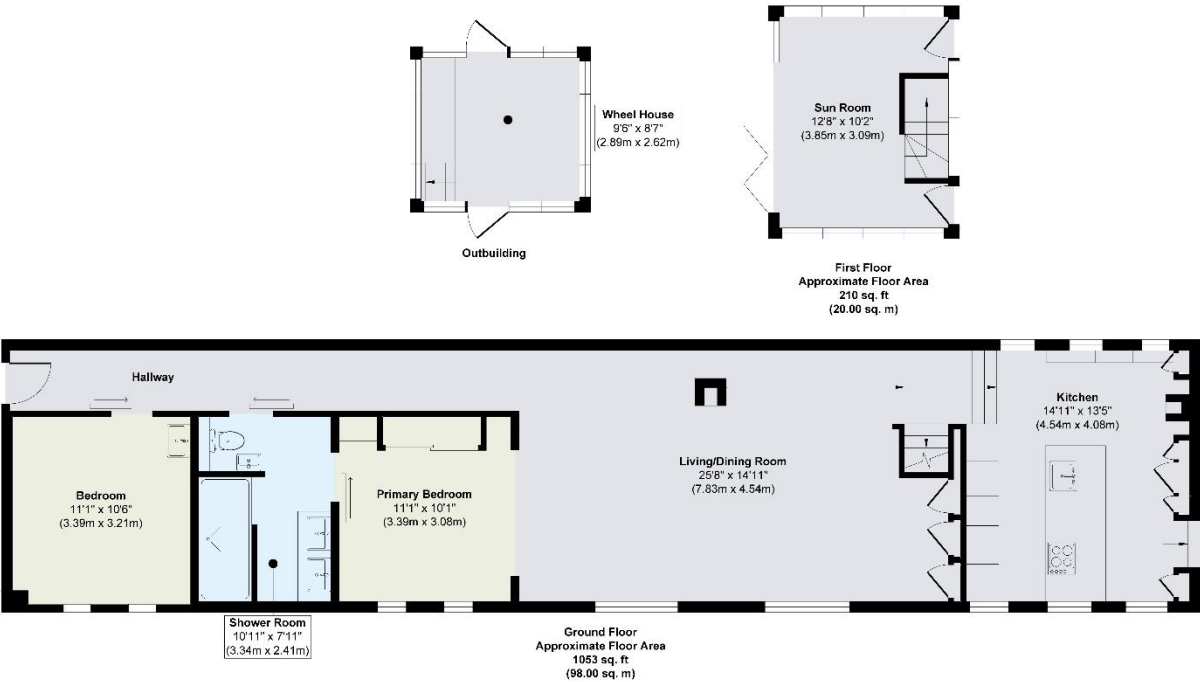

World Waterside Ltd trading as riverhomes for themselves and its clients give notice that 1: They are not authorised to make or give any representations or warranties in relation to the property either here or elsewhere, either on their own behalf or on behalf of their client or otherwise. 2: These particulars do not form part of any offer or contract and must not be relied upon as statements or representations of fact. Any areas, measurements or distances are approximate. The text, photographs and plans are for guidance only and are not necessarily comprehensive. 3: It should not be assumed that the property has all necessary planning, building regulation or other consents and any services, equipment or facilities have not been tested. 4: Lease details, service charges, ground rent (where applicable) and council tax are given as a guide only and should be checked and confirmed by your Solicitor prior to exchange of contracts. 5: They assume no responsibility and any intending purchasers or tenants must satisfy themselves by inspection or otherwise as to the correctness of each of the statements contained within these particulars. If you require clarification of any points please contact us.