

RIVERHOMES

**Trade Tower
Battersea SW11**

**£600 per week
SHORT LET**



Trade Tower Battersea SW11

A large one bedroom apartment on the sixth floor of Plantation Wharf's Trade Tower. With far reaching views across London and the Thames, this apartment boasts plenty of natural light from the floor-to-ceiling windows. Presented with a bright and clean décor, this apartment features a fully integrated, open plan kitchen area with breakfast bar to seat four. The master bedroom is equipped with fitted wardrobes and a walk in closet area. The stylish bathroom features a double shower. Further benefits include underground parking, and bike store. Plantation

Wharf is a desirable development which benefits from 24 hour concierge, secure entry, a river frontage and on-site café. Located on the south banks of the Thames, it is close to the shops, eateries and bars of Battersea Square and Wandsworth Town. Transport links are at Wandsworth Town and Clapham Junction National Rail Station (Overground) and numerous bus connections. The Thames Clipper riverboat service on site provide connections to key commuter hubs including Canary Wharf, Tower Hill, London Bridge, Embankment and Waterloo.

KEY FEATURES

SHORT LET

1 bedroom

1 bathroom

Far reaching view

24-hour concierge

Underground parking

Great storage

Floor-to-ceiling windows

Council tax: £1,117.29 per annum approx.





KEY INFORMATION

Local authority: London Borough of Wandsworth

Internal area: 569 sq. ft. / 52.9 sq. m.

Council tax band: E

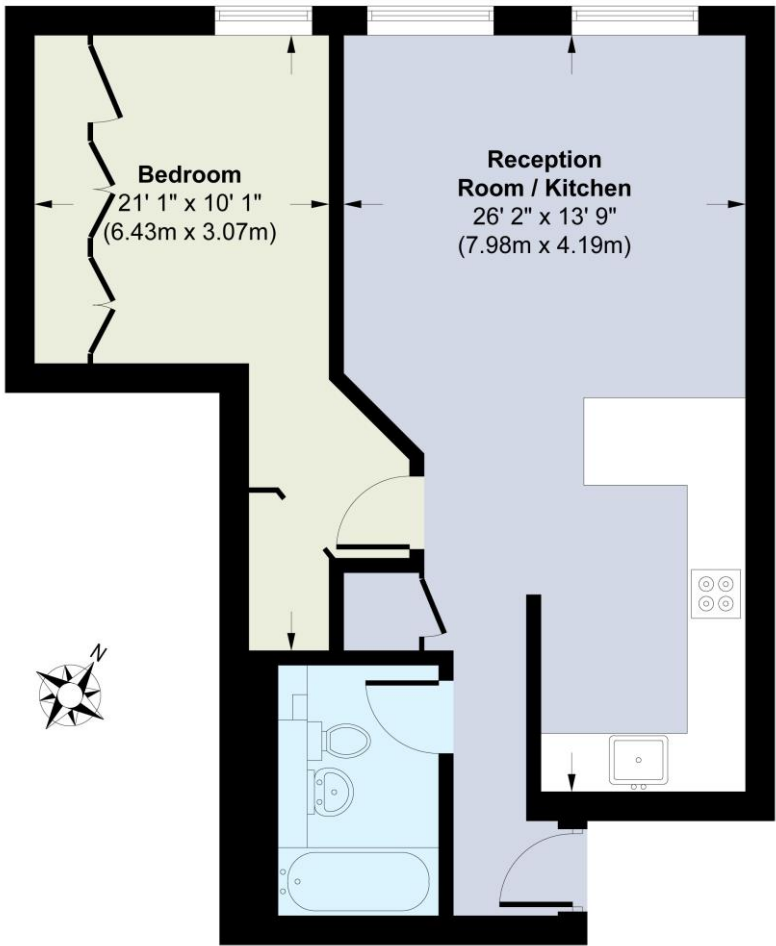

World Waterside Ltd trading as riverhomes for themselves and its clients give notice that 1: They are not authorised to make or give any representations or warranties in relation to the property either here or elsewhere, either on their own behalf or on behalf of their client or otherwise. 2: These particulars do not form part of any offer or contract and must not be relied upon as statements or representations of fact. Any areas, measurements or distances are approximate. The text, photographs and plans are for guidance only and are not necessarily comprehensive. 3: It should not be assumed that the property has all necessary planning, building regulation or other consents and any services, equipment or facilities have not been tested. 4: Lease details, service charges, ground rent (where applicable) and council tax are given as a guide only and should be checked and confirmed by your Solicitor prior to exchange of contracts. 5: They assume no responsibility and any intending purchasers or tenants must satisfy themselves by inspection or otherwise as to the correctness of each of the statements contained within these particulars. If you require clarification of any points please contact us.