

# RIVERHOMES

Currently moored at  
Cheyne Walk  
Chelsea SW10

£60,000  
Houseboat Only





**Currently moored at  
Cheyne Walk  
Chelsea SW10**

This charming split-level, one-bedroom houseboat offers a unique living experience. Accessed via the front deck, it provides stunning views and a perfect space for entertaining and al-fresco dining. The reception room is spacious and inviting, featuring wooden flooring that adds warmth and character to the space.

Descending the stairs to the lower deck, you'll find a fully fitted open-plan kitchen and dining area, ideal for culinary enthusiasts and social gatherings. The master bedroom boasts a triple aspect, allowing for plenty of natural light, and includes ample storage solutions. The

bathroom is well-appointed with a toilet, wash basin, and a bath, ensuring comfort and convenience.

Please note that this is a boat only and does not come with a mooring. The vessel's dimensions are as follows: overall length of 14.02 meters, beam of 3.42 meters, extreme depth of 1.37 meters, freeboard of 0.62 meters, and a draft of 0.90 meters.

**KEY FEATURES**

**Charming one-bedroom houseboat**

**Stunning views, ideal for entertaining and al-fresco dining**

**Fully fitted open-plan kitchen**

**Ample storage**

**Overall length: 14.02 meters**

**Beam: 3.42 meters**

**Mooring not included**







## KEY INFORMATION

**Internal area:** 621 sq. ft. / 57.73 sq. m.

**Garden area:** Deck

**No. of bedrooms:** 1

## CHEYNE WALK, CHELSEA SW10

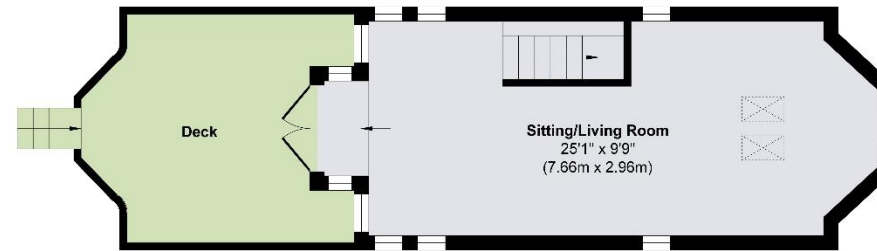

**First Floor**  
Approximate Floor Area  
223 sq. ft  
(20.72 sq. m)

