



St Katharine Docks Wapping E1W

Built specifically with the London market in mind, this 60 x 12'6 ft boat was built to the highest standards, using Farrow and Ball paint shades, Italian leather panelled doors and high-end appliances such as Smeg to create the perfect home. The design incorporates three doors in the wrap-around seating to ensure that once closed, this seated area complete with table, forms the perfect entertaining space. Fully covered by a tonneau cover, this provides shade from the sun as well as shelter from the rain and forms a useful storage area, acting like a porch. The central entrance leads into the saloon, with a flat screen TV mounted over the diesel stove heater. There is wrap-around shelving in the port and

starboard aft corners and plenty of cupboard storage. The sofa bed provides the ideal chill out area. The additional two berths mean 6 people can sleep on this craft.

St Katherine Docks marina offers excellent transport links; Tower Hill Underground and Tower Gateway DLR Stations are a short walk away. There are also numerous restaurants and bars located within the marina, offering residents and visitors a variety of options. Please note this is not Leasehold but a licence agreement for the mooring, call for further information.

KEY FEATURES

Measurements: 60 ft. x 12'6 ft.

Built to the highest standards

High end appliances

Seating area fully covered by a tonneau cover

Ample storage

Two berths

Mooring charges: £19,000 per year

Local authority: London Borough of Tower Hamlets





KEY INFORMATION

Local authority: London Borough of Tower Hamlets

Internal area: 641 sq. ft. / 59.60 sq. m.

No. of bedrooms: 2

ST KATHARINE DOCKS MARINA, E1W

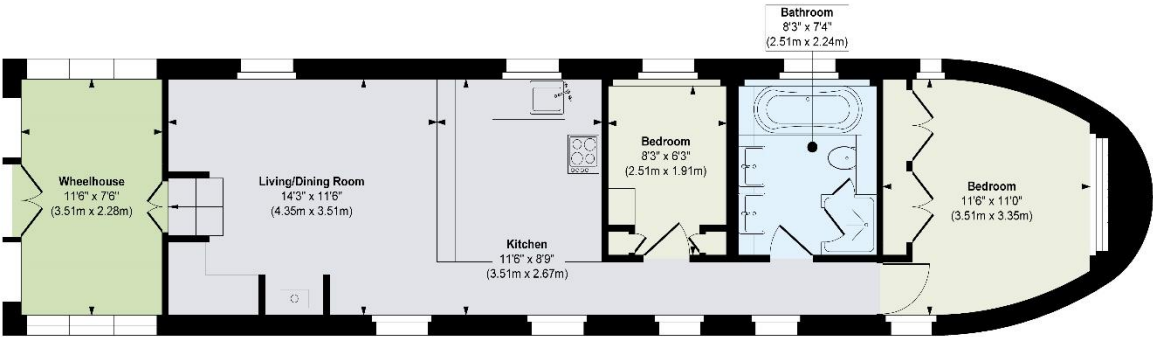

Approx. Gross Internal Floor Area 641 sq. ft / 59.60 sq. m

Illustration for identification purposes only, measurements are approximate, not to scale.

World Waterside Ltd trading as riverhomes for themselves and its clients give notice that 1: They are not authorised to make or give any representations or warranties in relation to the property either here or elsewhere, either on their own behalf or on behalf of their client or otherwise. 2: These particulars do not form part of any offer or contract and must not be relied upon as statements or representations of fact. Any areas, measurements or distances are approximate. The text, photographs and plans are for guidance only and are not necessarily comprehensive. 3: It should not be assumed that the property has all necessary planning, building regulation or other consents and any services, equipment or facilities have not been tested. 4: Lease details, service charges, ground rent (where applicable) and council tax are given as a guide only and should be checked and confirmed by your Solicitor prior to exchange of contracts. 5: They assume no responsibility and any intending purchasers or tenants must satisfy themselves by inspection or otherwise as to the correctness of each of the statements contained within these particulars. If you require clarification of any points please contact us.