

RIVERHOMES

**St Katharine Docks
Wapping E1W**

**£150,000
Leisure Mooring**



St Katharine Docks Wapping E1W

Blue Star is a beautiful example of a Princess 55. Broad in the beam and 55 foot in length, this boat feels very spacious and is awash with natural light. All the internal spaces offer excellent headroom and make Blue Star a pleasure to be aboard. The current owner has refurbished extensively and created a very comfortable and welcoming living space. Accommodation comprises two generous cabins, two wet rooms, a large saloon and an additional sun deck which can be completely enclosed to enjoy all year round. Powered by twin Volvo TMD engines which kick out an impressive

480 horse power per unit, Blue Star is a great cruising boat as well as an attractive and very functional pied a terre. Moored at St Katherine Docks, the dock offers excellent transport links - Tower Hill Underground and Tower Gateway DLR Stations are a short walk away. There are also numerous restaurants and bars located within the marina, offering residents and visitors a variety of options.

KEY FEATURES

Two cabins, two wet rooms

Sun deck

Ample storage

Additional seating on Flybridge

Excellent transport links

Internal area: 547 sq ft. / 51 sq. m.

Length: 55 ft. / 17 m.

Mooring charges : £13,880 per year approx.

Local Authority: London Borough of Tower Hamlets

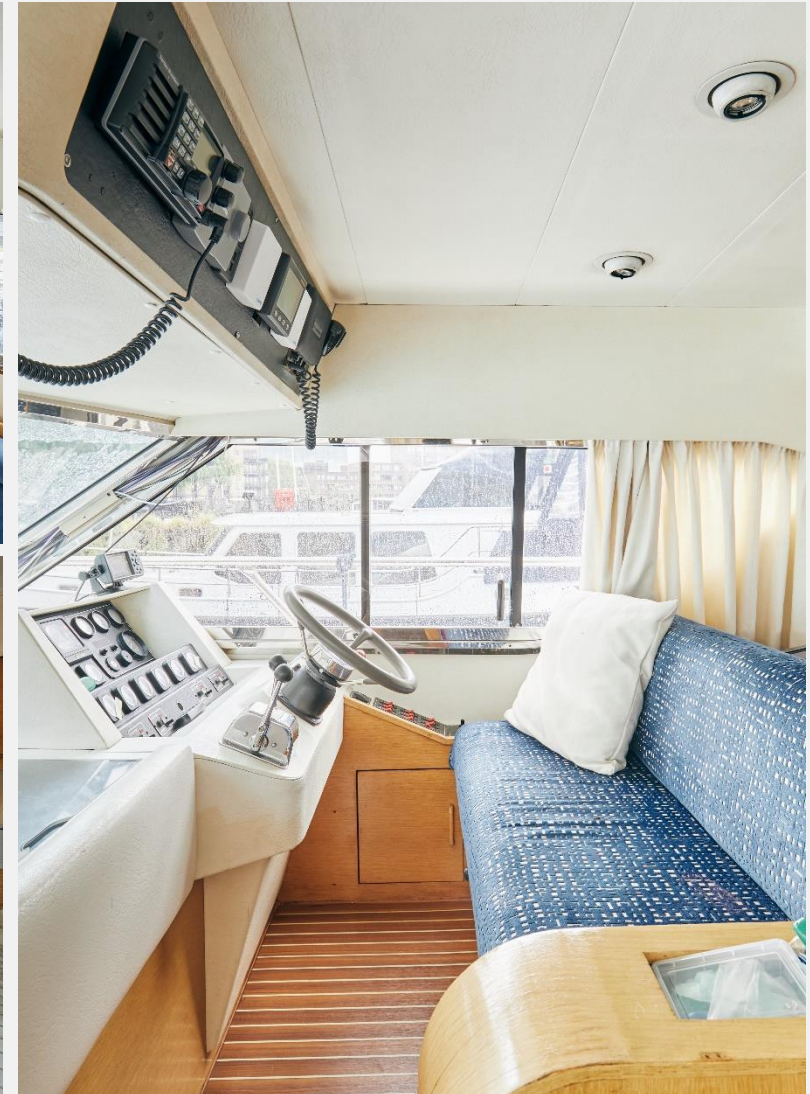



KEY INFORMATION

Local authority:	London Borough of Tower Hamlets
Internal area:	547 sq. ft. / 51 sq. m.
Garden area:	Sun Deck
No. of cabins:	2

Blue Star, St. Katharines Way London, E1W

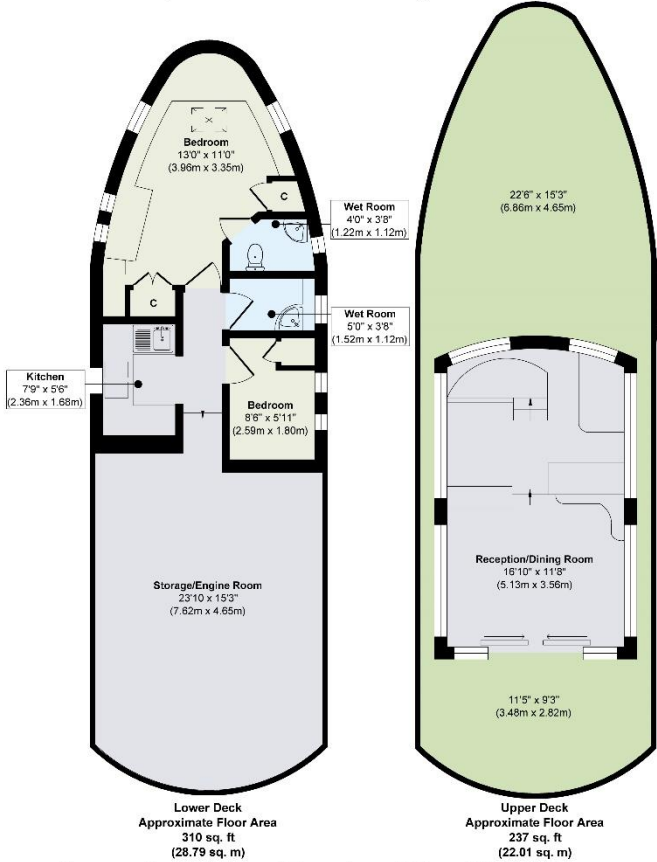

World Waterside Ltd trading as riverhomes for themselves and its clients give notice that 1: They are not authorised to make or give any representations or warranties in relation to the property either here or elsewhere, either on their own behalf or on behalf of their client or otherwise. 2: These particulars do not form part of any offer or contract and must not be relied upon as statements or representations of fact. Any areas, measurements or distances are approximate. The text, photographs and plans are for guidance only and are not necessarily comprehensive. 3: It should not be assumed that the property has all necessary planning, building regulation or other consents and any services, equipment or facilities have not been tested. 4: Lease details, service charges, ground rent (where applicable) and council tax are given as a guide only and should be checked and confirmed by your Solicitor prior to exchange of contracts. 5: They assume no responsibility and any intending purchasers or tenants must satisfy themselves by inspection or otherwise as to the correctness of each of the statements contained within these particulars. If you require clarification of any points please contact us.