



River Gardens Fulham SW6

An immaculate and spacious one bedroom apartment with a private, river-facing terrace in the popular River Gardens development. This property has been meticulously refurbished throughout with high quality hardwood floor in all the main rooms. There is a new bathroom, fully-fitted kitchen and ample storage throughout. The development has security controlled access at the entrances so is very safe and there is a concierge team on site. The apartment is sold with one underground parking space.

Stevenage Road is moments from the expanse of Bishops Park and the Thames Path. Transport links can be found at Putney Bridge and Parsons Green (District Line) and the Fulham Palace Road offers many bus routes into the city. For the motorist, there is easy access onto the A4/M4 towards Heathrow and out of London. River Gardens is located on the banks of the River Thames opposite the London Wetlands Centre at Barnes. The nearest tube station is at Putney Bridge.

KEY FEATURES

Spacious one double bedroom apartment

River-facing terrace

Refurbished throughout

Fully fitted kitchen and ample storage

Concierge service

Access to swimming pool

Council tax: Band D - £1,227.55 for 2022/23

Service charges: £3,568 approx. per year

Lease length: until 19/02/2974





ENERGY PERFORMANCE CERTIFICATE

Score	Energy rating	Current	Potential
92+	A		
81-91	B		
69-80	C	70 c	70 c
55-68	D		
39-54	E		
21-38	F		
1-20	G		

KEY INFORMATION

Local authority:	London Borough of Hammersmith and Fulham
Internal area:	702 sq. ft. / 65 sq. m.
Garden area:	Terrace
No. of bedrooms:	1

ALDER LODGE, FULHAM SW6

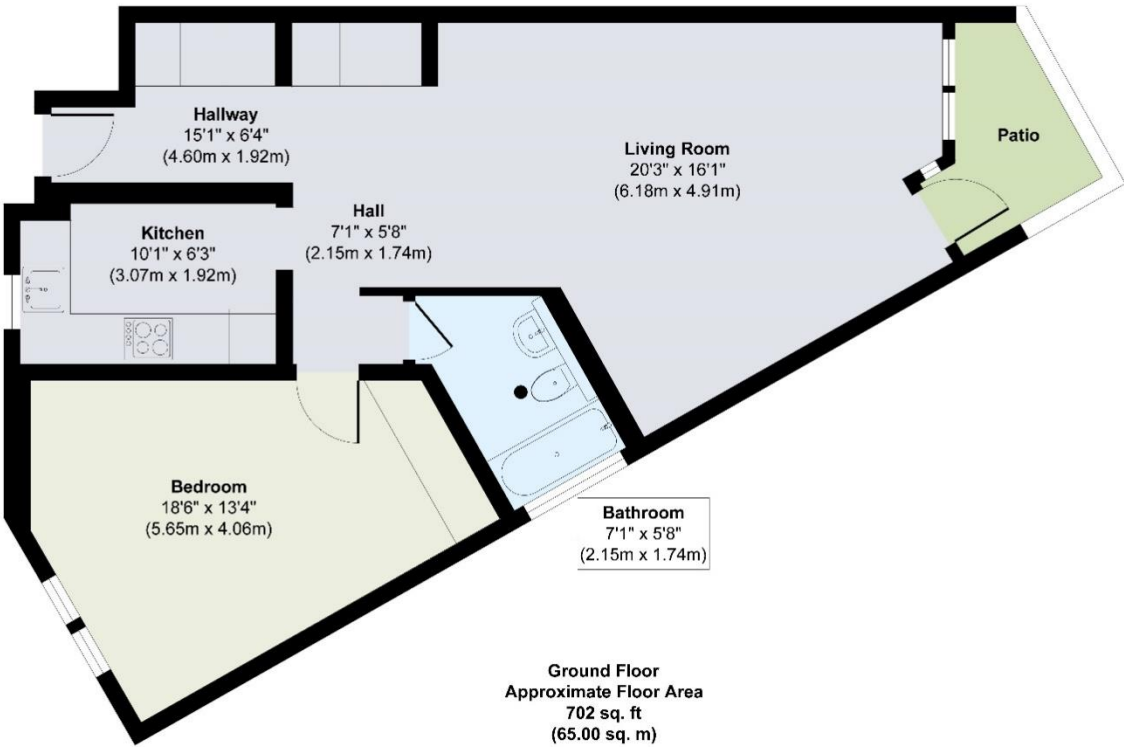

Ground Floor
Approximate Floor Area
702 sq. ft
(65.00 sq. m)
Approx. Gross Internal Floor Area 702 sq. ft / 65.00 sq. m
Illustration for identification purposes only. measurements are approximate, not to scale.
Produced by Elements Property

World Waterside Ltd trading as riverhomes for themselves and its clients give notice that 1: They are not authorised to make or give any representations or warranties in relation to the property either here or elsewhere, either on their own behalf or on behalf of their client or otherwise. 2: These particulars do not form part of any offer or contract and must not be relied upon as statements or representations of fact. Any areas, measurements or distances are approximate. The text, photographs and plans are for guidance only and are not necessarily comprehensive. 3: It should not be assumed that the property has all necessary planning, building regulation or other consents and any services, equipment or facilities have not been tested. 4: Lease details, service charges, ground rent (where applicable) and council tax are given as a guide only and should be checked and confirmed by your Solicitor prior to exchange of contracts. 5: They assume no responsibility and any intending purchasers or tenants must satisfy themselves by inspection or otherwise as to the correctness of each of the statements contained within these particulars. If you require clarification of any points please contact us.